

KEENETIC ORBITER 6

Quick Start Guide

AX3000 Wi-Fi 6 Access Point with a 2.5 Gigabit Ethernet Port and Power over Ethernet
Model: KAP-630



Need help in another language?
Scan the QR code to access the multilingual Quick Start Guide.
<https://keenetic.com/qsg/kap-630>

For technical support and other information, please visit
support.keenetic.com

Package contents

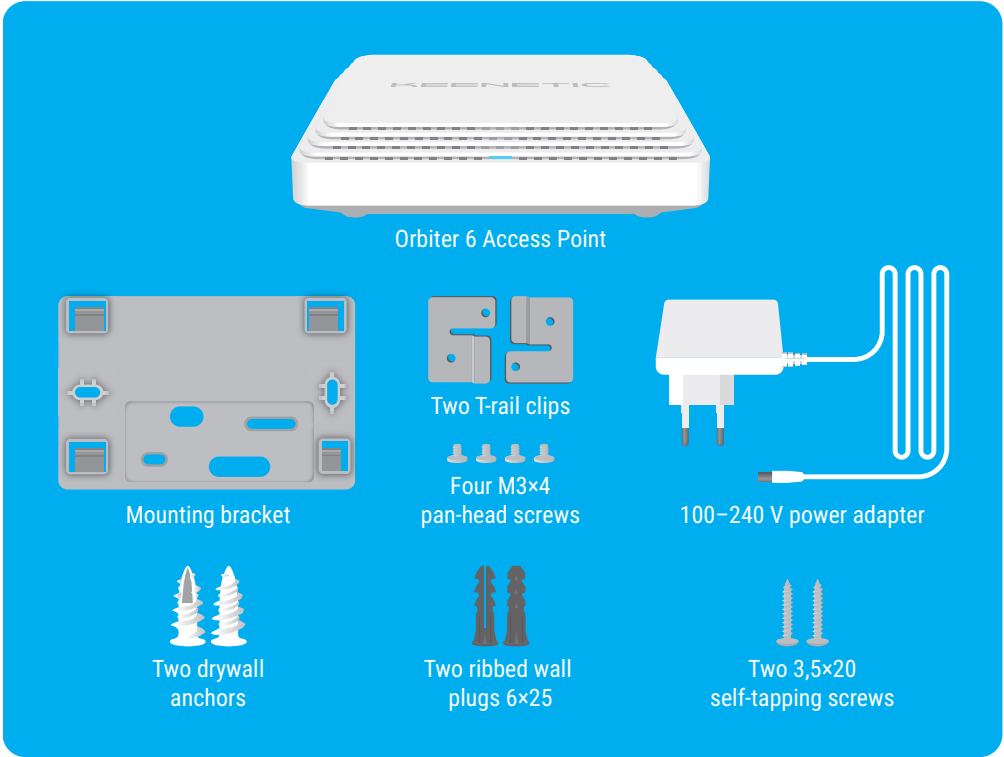

Overview

1. Status LED

Blinking green – The Keenetic Orbiter 6 Access Point (hereinafter 'Keenetic Access Point', 'Keenetic device') is starting up or updating its operating system.
Solid green – Internet connection is available.
Solid orange – No Internet connection.
Off – Off.

2. Kensington Security Slot™

The Kensington Security Slot™ lets you attach a compatible lock to protect your Keenetic Access Point from theft.

3. Network Port 0 - PoE

The Ethernet port supports speeds up to 2.5 Gbps and connects to a gateway, router, or switch. It works with PoE Ethernet switches that provide 802.3at power (PoE+) and data over a single Ethernet cable.

4. Reset Button

Restores the original factory settings and resets the administrator password. For instructions on how to reset your Keenetic Access Point to factory settings, see the Frequently Asked Questions section below.

5. DC Power Socket

For use with the supplied power adapter. Alternatively, the Access Point can be powered via the PoE Ethernet switch. If both PoE and DC power sources are available, the DC power source takes priority.

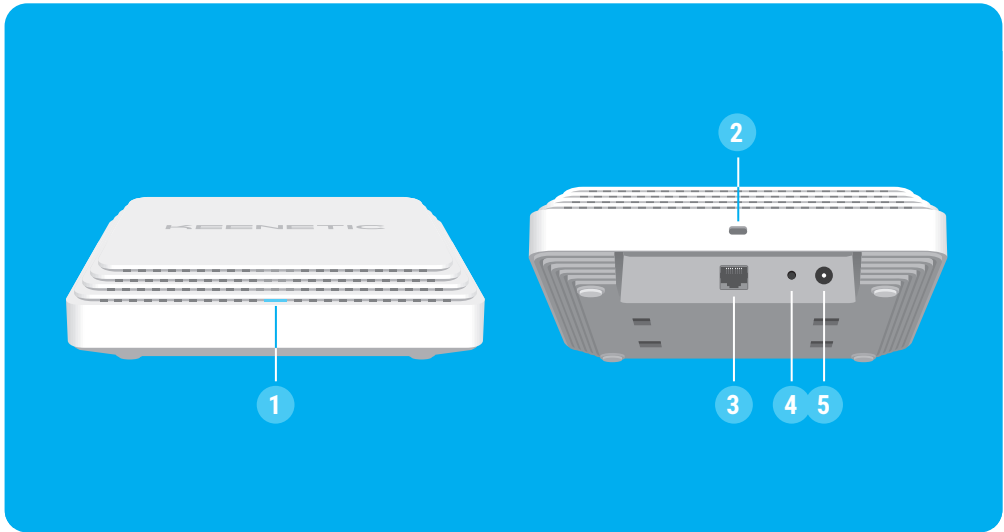

Mounting Options

This Keenetic Access Point can be placed on a flat surface or attached to a wall or solid ceiling using the supplied mounting kit, or to a suspended ceiling using the mounting kit and T-rail clips.

Mounting to a Wall or Solid Ceiling

1. Place the mounting bracket in the desired position. Ensure that the installation does not interfere with existing electrical or network wiring.
2. Mark two screw hole positions. Drill a 6 mm diameter hole in each of the marked spots.
3. Insert the ribbed plastic wall plugs into the holes. Or, in the case of a drywall surface, screw the drywall anchors in with a screwdriver.
4. Secure the mounting bracket to the wall or ceiling by driving the self-tapping screws into the anchors.
5. Connect the Ethernet cable and, if necessary, the power adapter to the Keenetic Access Point.
6. Attach the Keenetic Access Point to the mounting bracket and move it in the direction of the arrows until it locks into place.

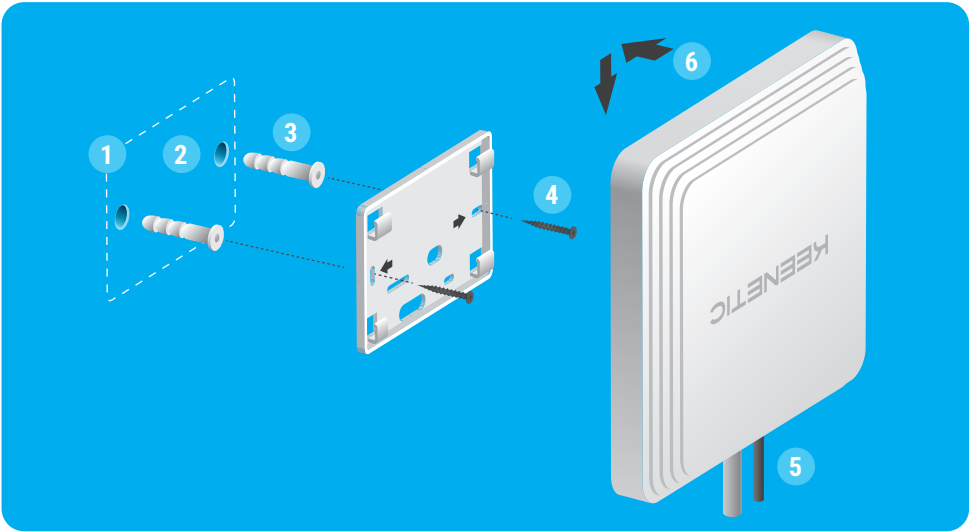

Mounting to a Suspended Ceiling Using T-rails

1. Secure the first T-rail clip to the mounting bracket with a screw. Depending on the T-rail size, use the 9/16" (14.3 mm) or 15/16" (23.8 mm) position.
2. Hook the second T-rail clip to the mounting bracket. Do not tighten the screw at this time.
3. Position the mounting bracket on the T-rail by placing the first T-rail clip on the rail base and pushing the second clip toward the rail base. Tighten the second screw.
4. Secure the mounting bracket to the T-rail with the two remaining screws.
5. Connect the Ethernet cable to the Keenetic Access Point.
6. Attach the Keenetic Access Point to the mounting bracket and move it in the direction of the arrows until it locks into place. Adjust the cables so that the exposed parts are hidden behind the case.

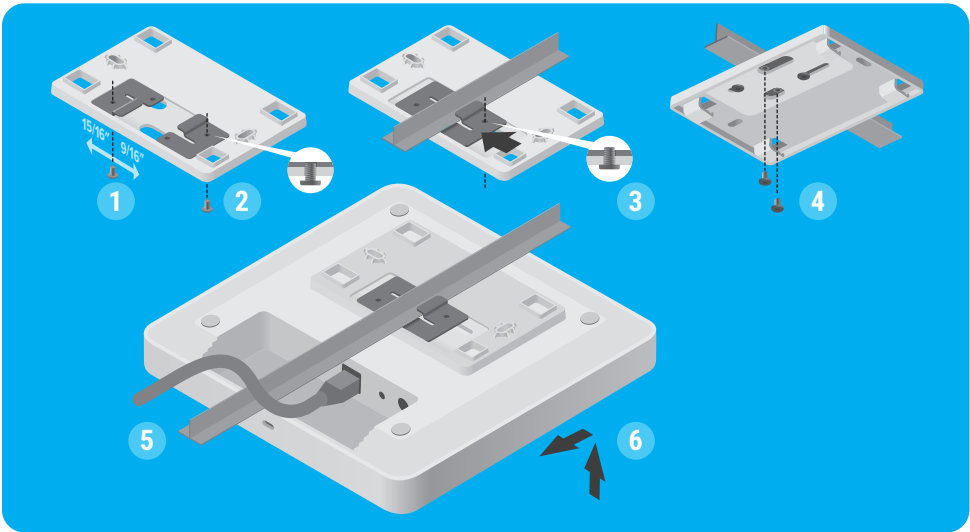

Standalone Installation

If your network only requires a few Wi-Fi access points, you can configure and manage them separately via their Web Interfaces.

1.

Power up and connect the devices as shown in the topology diagram. Ensure that a DHCP server (e.g. a router with DHCP enabled) is active to assign IP addresses to network devices. Check that the Status LED on the Keenetic Access Point is solid orange or green.
2.

Connect a mobile device / computer to the gateway / router network.
3.

To configure the settings, first open the gateway / router's user interface to determine the IP address assigned to your Keenetic Access Point. This can usually be found under the 'Connected Devices' or 'DHCP Clients' section. Then enter this IP address in your web browser to open the Keenetic Access Point Web Interface. The Initial Setup Wizard screen will appear. Follow the instructions to set up your Keenetic Access Point.

Note: If your network does not include a DHCP server, the Keenetic Access Point uses its default IP address: 192.168.1.3

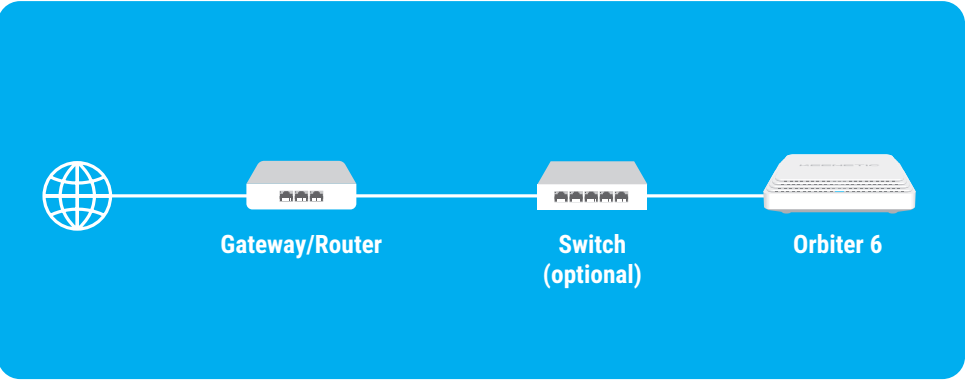

Installation with Controller

If your network uses a Keenetic as the Main Router and controller of a Mesh Wi-Fi System, add your Keenetic Access Point to the system for centralised, controller-based management and monitoring.

1.

Power up and connect the devices as shown in the topology diagram. Check that the Status LED on the Keenetic Access Point is solid orange or green.
2.

Connect a mobile device / computer to your Keenetic Main Router network.
3.

Launch a web browser and go to **my.keenetic.net** and log in to the Main Router or launch the **Keenetic mobile application**. Then select the **Wi-Fi System** section and click **Acquire** to add Keenetic Access Point to your Wi-Fi System. Wait for the process to complete.

Note: If Keenetic Access Point does not appear on the Wi-Fi System page, follow the instructions for resetting Keenetic Access Point in the Frequently Asked Questions section.

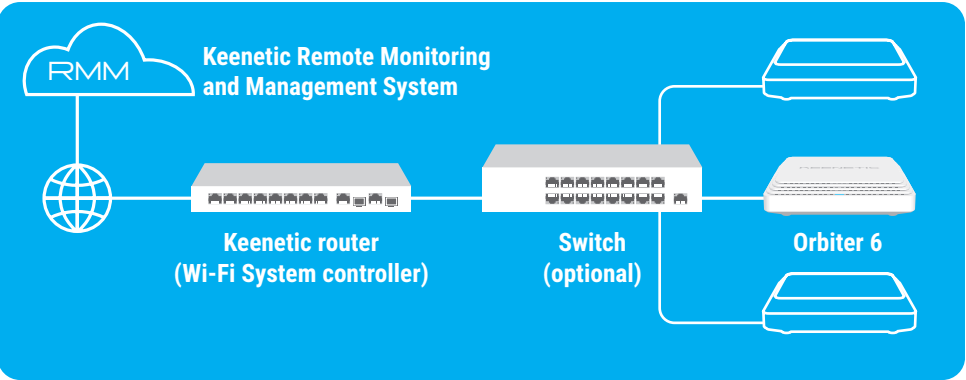

Frequently Asked Questions

What should I do if I can't add an Access Point to the Keenetic Mesh Wi-Fi System?

Restore the factory settings of your Keenetic Access Point (see below), and repeat the procedure of adding it to the Mesh Wi-Fi System.

What should I do if I can't access the Internet with my Keenetic Access Point?

1.

If the **Status LED** on the Keenetic Access Point is steady orange:
 - Check if your main router is on and operating normally and has access to the Internet.
 - Check the Ethernet cable.
2.

If the **Status LED** on the Keenetic Access Point is steady green, make sure that your mobile device / computer is connected to the right Wi-Fi network and set up to obtain an IP address and DNS servers automatically.

What should I do if I forget my Web Interface page password?

To create a new password, please follow the instructions to restore the factory settings on your Keenetic Access Point in the question below.

How do I reset/restore the original factory settings?

Make sure that your Keenetic Access Point is connected to a power supply. Press and hold the **Reset Button**  until the **Status LED** begins to blink green rapidly, release the button and wait while your Access Point restarts.

Important: After restoring factory settings, you will need to add the Keenetic Access Point back to your Mesh Wi-Fi System or manually reconfigure it.

Safety Instructions

- Your Keenetic device is designed for indoor use only and must not be used outdoors.
- Before use, remove protective labels from your Keenetic device, and ensure vents are unblocked.
- Never use your Keenetic device in an enclosed space, and ensure that the Keenetic-supplied power adapter is always easily accessible.
- Use only the Keenetic-supplied power adapter. Discontinue using a damaged adapter immediately.
- Your Keenetic device and its power adapter contain no user-serviceable parts – DO NOT OPEN.
- Keep your Keenetic device away from water, excessive humidity or heat, and direct sunlight.

Environmental Conditions

- Operating temperature range: 0 to +40 °C.
- Operating humidity: 20 to 95% non-condensing.
- Storage temperature range: –30 to +70 °C.
- Storage humidity: 10 to 95% non-condensing.

Certification Information

Keenetic Limited hereby declares that this device is in compliance with all relevant provisions of directives 2014/53/EU, 2009/125/EC, and 2011/65/EU. Details of the original EU declaration are available at **keenetic.com** on the specific model pages.

This device complies with EU radiation exposure limits set forth for an uncontrolled environment.

This equipment should be installed and operated with a minimum distance of 20 cm between the antennas and a person's body.

The frequency and the maximum transmitted power for your device, per the requirements of the EU are listed below:

2400-2483.5 MHz: 20 dBm;
5150-5350 MHz: 23 dBm;
5470-5725 MHz: 30 dBm.

This device will support DFS and TPC functionality while operating in the 5 GHz band.

| | | | | | | | |
|---|----|----|----|----|----|----|----|
|  | AT | BE | BG | CH | CY | CZ | DE |
| | DK | EE | EL | ES | FI | FR | HR |
| | HU | IE | IS | IT | LI | LT | LU |
| | LV | MT | NL | NO | PL | PT | RO |
| | SE | SI | SK | TR | UA | UK | |

This device is restricted to indoor use only when operating in 5150 to 5350 MHz frequency range (channels 36 - 64).

Per (EC) No 1275/2008, the power consumption in networked standby if all wired network ports are connected and all wireless network ports are activated is 6,1 W.

This device can be used across EU member states.

Device Warranty

For the most up-to-date Warranty Information, please visit our website, **keenetic.com/legal**.

Your Keenetic device comes with a non-transferable 3-year warranty from the documented date of purchase (including your 2-year European Limited Warranty). Valid claims in case of a defect will be honoured subject to local legal requirements.

Notice

When you use your Keenetic device (including when you connect your Keenetic device the first time), Keenetic Limited will process certain personal data about you, e.g., service tag, serial number, model name, software version, and IP address of your Keenetic device.

For more information, please go to **keenetic.com/legal**.

If you are in the European Union / European Economic Area, Keenetic GmbH will process certain personal data about you, e.g., service tag, serial number, model name, software version, and IP address of your Keenetic Router. Please read our Device Privacy Notice for the European Union / European Economic Area at **keenetic.com/legal**.

Disposal

In accordance with European directives, your Keenetic device, including the power adapter and cables may not be disposed of with general household waste. Consult your local authority or your supplier for information about disposal.

